



## ENE0 LAN-02

1/3" Network Colour Camera, F1.0/3-8mmDC  
in VHM Weatherproof Housing, 480TVL

Art-No. 96055



## Features

**1/3" CCD Colour Camera with MJPEG Compression**  
**Lens: F1.0/3-8mm with DC Controlled Iris**  
**Transmission Rate: Upto 25 Frames/Sec.**  
**E-Mail and FTP Transmission of Important Events**  
**Activity Detection**  
**Ethernet Interface: 10/100Base-T**

**Supports Various Network Environments**  
**Weatherprotected Housing with 24V Screen Heater**  
**Plugable Connector with 3m Multicore Cable**  
**Viewing Screen with "Clear-Shield" Technology**  
**Surface: RAL7032**  
**Wall Bracket WD-16**

## Specifications

<b>Imager</b>	1/3" interlaced CCD
<b>Resolution</b>	480 TV lines (camera) 720x576, 352x288
<b>Sensitivity at 50% video signal</b>	0.52Lux at F1.0 (VT measurement result)
<b>Automatic shutter control (AES)</b>	1/50 - 1/100,000Sec.
<b>Activity detection</b>	Integrated motion detector
<b>Focal length (f)</b>	3-8mm
<b>Horizontal angle of view</b>	91°-36°
<b>Aperture range</b>	F1.0-F360
<b>Iris control system</b>	Galvanometer
<b>Minimum object distance (M.O.D.)</b>	0.2m
<b>Focus constant range</b>	+0.02mm (Focus deviation at switch-over to IR light at 880nm)
<b>Window screen</b>	and screen cleaning cycles will be extended. The coating is UV light resistant, colour neutral and it causes no F-stop loss.
<b>Window heater</b>	24V, approx. 6watts, with thermostat (On: +16°C, Off: +20°C)
<b>Cable entry</b>	Metal gland M20x1.5mm
<b>Cable connection</b>	3m Multicore cable with open ends

## ENE0 LAN-02

(Specifications continued)

<b>Mounting distance from fixing point</b>	300mm
<b>Turning range of the swivel head</b>	360°
<b>Tilt range</b>	Approx. 50°
<b>Protection rating</b>	IP66
<b>Secondary Storage</b>	Via CF card
<b>Recording</b>	on PC with Viewer Software or on CF Card on camera side
<b>Video output</b>	1 Vp-p, CVBS, 75 ohms, BNC
<b>Compression standard</b>	M-JPEG
<b>Frame rate</b>	25 frames/sec. max.(recording mode), up to 15 frames/sec. (streaming mode)
<b>Transmission rate</b>	up to 15 frames/sec.
<b>Video ring buffer</b>	Stores alarms up-to 3 min.
<b>Image display</b>	Via Web Browser or Lan-Cam-Viewer Software
<b>Alarm input</b>	1 (software controlled)
<b>Alarm outputs</b>	Open collector (5V / 0.02A max.)
<b>Alarm handling</b>	Automatic connection setup to a specified IP address. Sending e-mail with alarm picture (JPEG) automatically
<b>Ethernet interface</b>	10/100 Base-TX, RJ45
<b>Ethernet protocols</b>	TCP, UDP, IP, ARP, ICMP, FTP, DHCP, PPP, HTTP, IGMP
<b>Software upgrade</b>	Via CF card (FAT16 formatted)
<b>Operation protection</b>	Multilevel and Multiuser - Password protected
<b>Serial interfaces</b>	RS-232, RS-485, RJ 45 connector
<b>Supply voltage</b>	230VAC/50Hz
<b>Housing</b>	Aluminium
<b>Colour</b>	RAL7032
<b>Temperature range</b>	-10°C ~ +50°C
<b>Dimensions (HxWxD)</b>	See drawing
<b>Weight</b>	Approx. 3.5kg
<b>Parts supplied</b>	230V/50Hz, Screw set, Central plug with built-in 30-pin connector, Wall bracket

## Accessories

<b>71852 / CF CARD/128</b>	CF Memory Card 128MB for ENC-1001L,
<b>71853 / CF CARD/256</b>	CF Memory Card 256MB for ENC-1001L,
<b>70456 / AK-2</b>	Camera Connection Box for Standard and

## Accessories of

<b>71856 / DNR-108/80</b>	Digital IP Recorder (8 Channel), 80Gb
<b>71875 / DNR-108/80W</b>	Digital W LAN IP Recorder

## Product Information

Viewer Software for the recording of upto 4 cameras ENC-1002P

System requirements for the Viewer Software:

1.8GHz system clock

- Windows 2000 or Win XP (in preparation)
- Network connection 10/100 Base-Tx
- Internet Explorer 5 or higher
- Hard disk 80Gb, depend on recording demand
- RAM 512Mb (recommended)

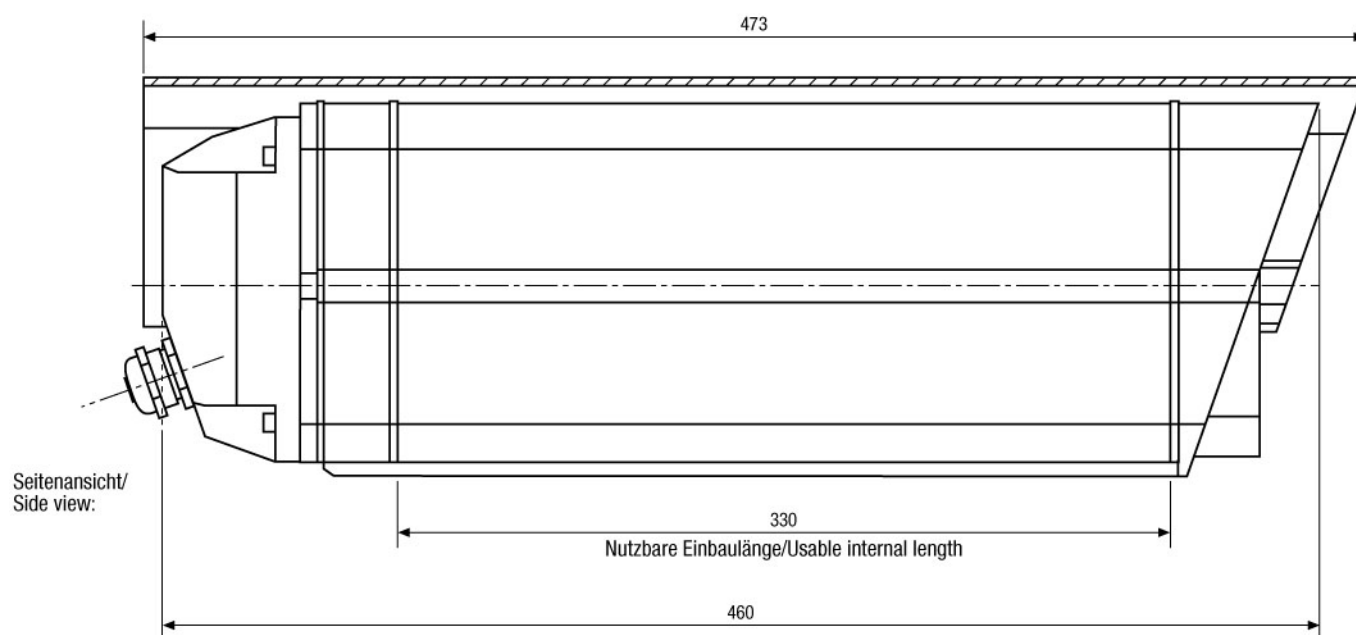
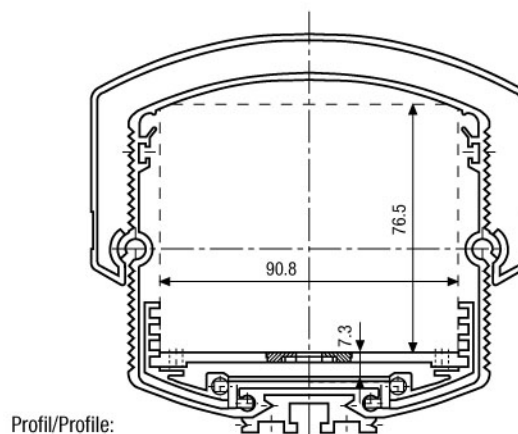
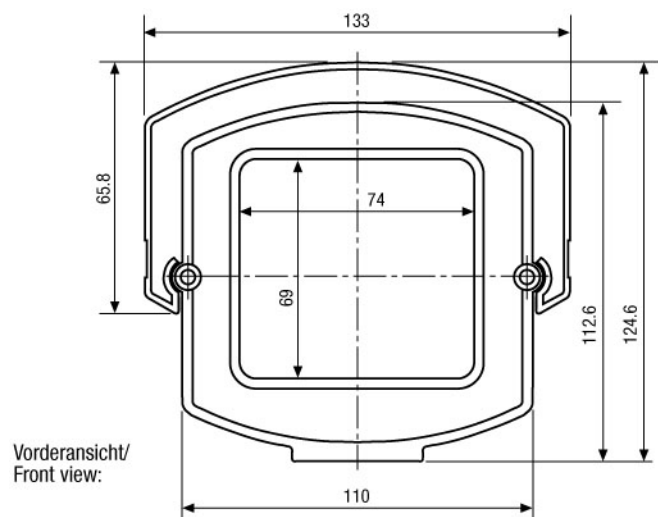

Maße/Dimensions: mm

VIDEOR TECHNICAL E. Hartig GmbH  
 Carl-Zeiss-Straße 8 · 63322 Rödermark · Germany  
 Telefon +49 (0) 60 74/8 88-0 · Telefax +49 (0) 60 74/8 88-100  
 info@videortechnical.com · www.videortechnical.com