

## TYPICAL SWITCH ORDERING EXAMPLE

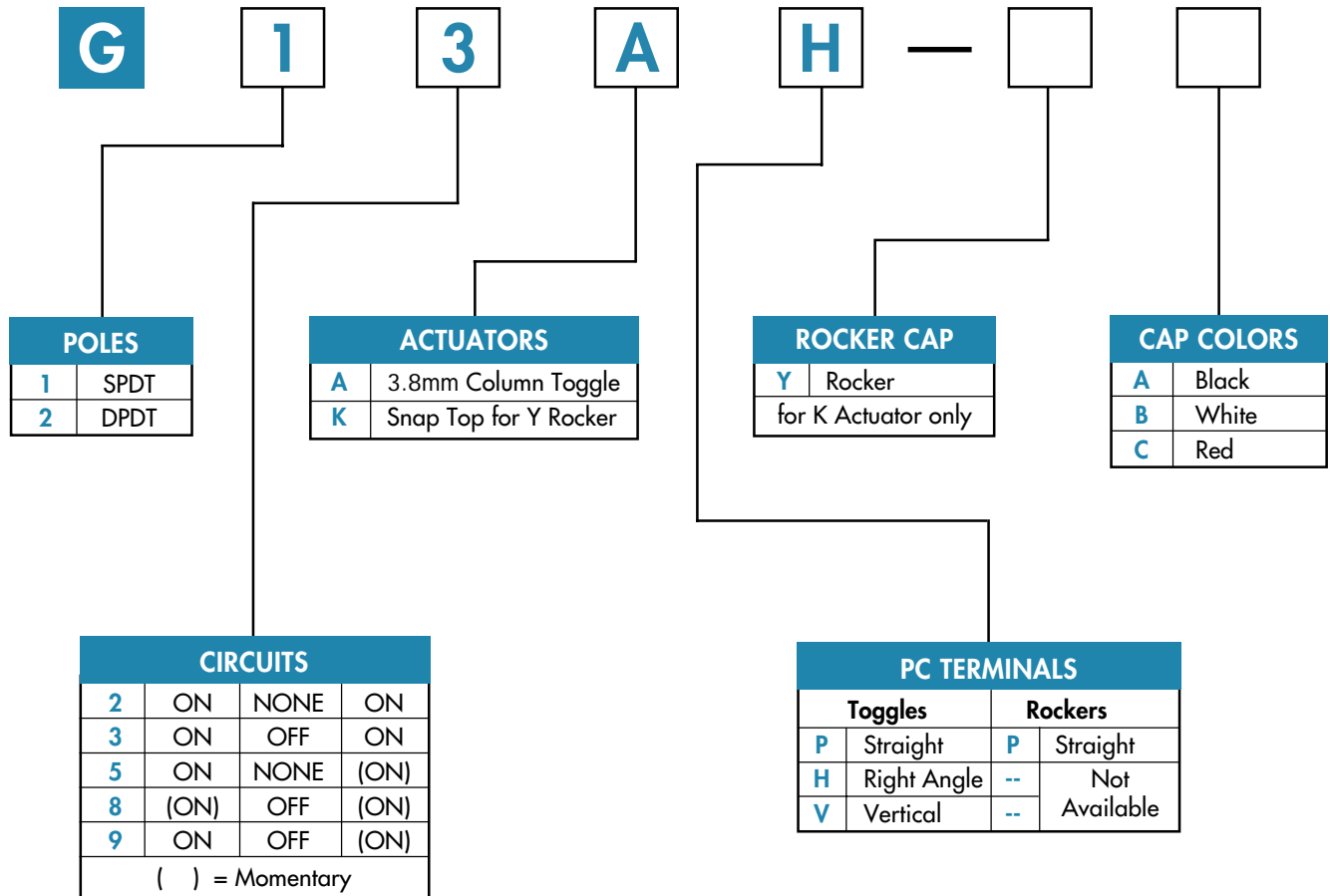

### DESCRIPTION FOR TYPICAL TOGGLE ORDERING EXAMPLE

**G13AH**

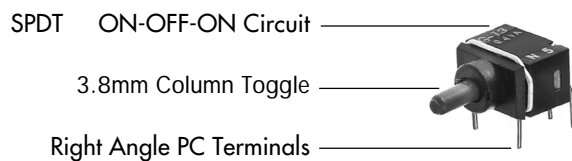

### DESCRIPTION FOR TYPICAL ROCKER ORDERING EXAMPLE

**G22KP-YA**

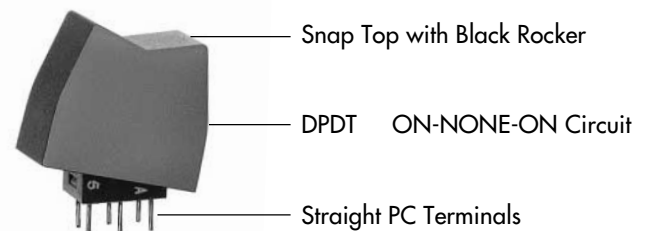



## GENERAL SPECIFICATIONS

### Electrical Capacity (Resistive Load)

**Logic Level:** 0.4VA maximum @ 28V AC/DC maximum  
(Applicable Range 0.1mA ~ 0.1A @ 20mV ~ 28V)

Note: See [Supplement Index](#) to find explanation of operating range.

### Other Ratings

**Contact Resistance:** 80 milliohms maximum

**Insulation Resistance:** 500 megohms minimum @ 500V DC

**Dielectric Strength:** 500V AC minimum

**Mechanical Life:** 100,000 operations minimum for On-None-On & On-Off-On  
50,000 operations minimum for other circuits

**Electrical Life:** 100,000 operations minimum for On-None-On & On-Off-On  
50,000 operations minimum for other circuits

**Nominal Operating Force:** Toggles: 95 grams for momentary & 122 grams for maintained  
Rockers: 83 grams for momentary & 108 grams for maintained  
Pushbuttons: 200 grams

**Contact Bounce:** 1 millisecond

**Toggle & Rocker Angle of Throw:** 28°

**Pushbutton Travel:** Pretravel 0.9mm (.035") Overtravel 0.2mm (.008") Total 1.1mm (.043")

### Materials & Finishes

**Actuator for Toggles & Rockers:** Glass fiber reinforced polyamide

**Actuator for Pushbuttons:** Polyacetal

**Case:** Glass fiber reinforced polyamide

**Sealing Rings:** Nitrile butadiene rubber

**Movable Contacts:** Phosphor bronze with gold plating over nickel

**Stationary Contacts:** Phosphor bronze with gold plating over nickel

**Base:** Glass fiber reinforced polyamide

**Terminals:** Phosphor bronze with gold plating over nickel

### Environmental Data

**Operating Temp Range:** -30°C through +85°C (-22°F through +185°F) for toggles & rockers  
-40°C through +85°C (-40°F through +185°F) for pushbuttons

**Humidity:** 90 ~ 95% humidity for 96 hours @ 40°C (104°F)

**Vibration:** 10 ~ 500Hz with peak-to-peak amplitude of 1.5mm traversing the frequency range  
& returning in 1 minute; 3 right angled directions for 2 hours

**Shock:** 50g acceleration (tested in 6 right angled directions, with 5 shocks in each direction)

### Installation

**Soldering Time & Temperature:** 3 seconds @ 350°C or 5 seconds @ 270°C

**Process Seal:** See [Supplement Index](#) for specific processing data.

### Standards & Certifications

**IECQ Approved:** All toggle & pushbutton models recognized at 0.4VA maximum @ 28V AC/DC maximum  
Qualification Approval Numbers:

G Toggle Switches JP792-7A







GB Pushbutton Switches JP792-6A



# Series G

Washable Ultra-Miniature Switches

## POLES & CIRCUITS

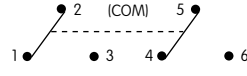
		Toggle Position ( ) = Momentary			Connected Terminals			Throw & Schematics
Pole	Model	Up 	Center 	Down 	Up 	Center 	Down 	Note: Terminal numbers are not actually on the switch.
SP	G12	ON	NONE	ON	2-3	OPEN	2-1	SPDT 
	G13	ON	OFF	ON				
	G15	ON	NONE	(ON)				
	G18	(ON)	OFF	(ON)				
	G19	ON	OFF	(ON)				
DP	G22	ON	NONE	ON	2-3 5-6	OPEN	2-1 5-4	DPDT 
	G23	ON	OFF	ON				
	G25	ON	NONE	(ON)				
	G28	(ON)	OFF	(ON)				
	G29	ON	OFF	(ON)				

## ACTUATORS

**A** 3.8mm Column Toggle

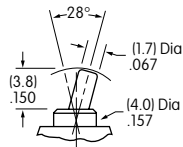

**K** Snap Top for Rocker

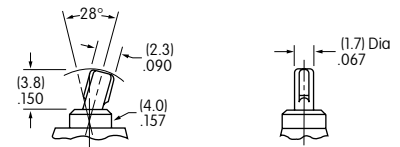

## PC TERMINALS

**P** Straight

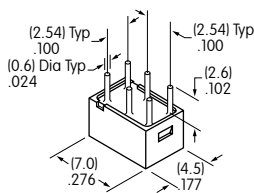

**H** Right Angle

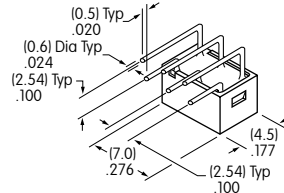

**V** Vertical

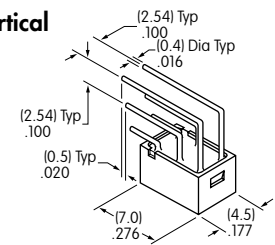

Not Available for Rocker

## ROCKER CAP & COLORS

**Y** AT4062 Rocker

Material: Polyamide

Finish: Matte



Actual Size

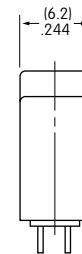
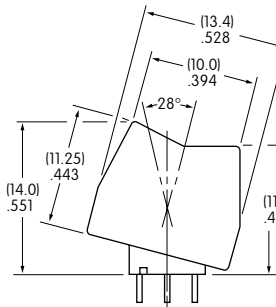

Cap Colors Available:

**A** Black

**B** White

**C** Red

### TYPICAL SWITCH DIMENSIONS

#### Straight PC



G19AP

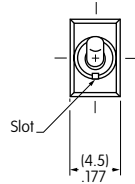

#### Single & Double Pole

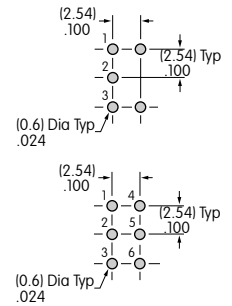
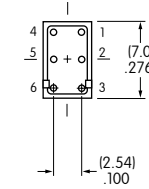
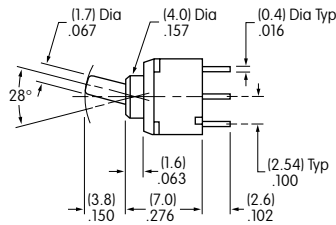

On single pole switches terminals 4 & 6 are support pins.

#### Right Angle PC



G19AH

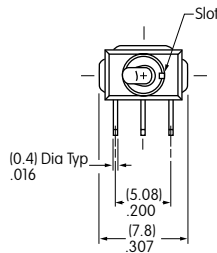

#### Single & Double Pole

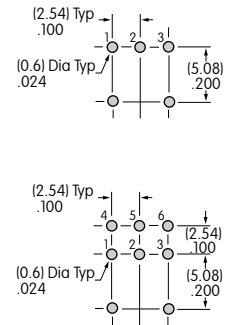
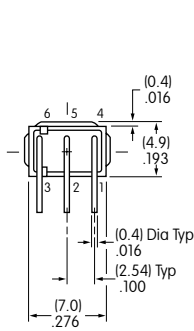
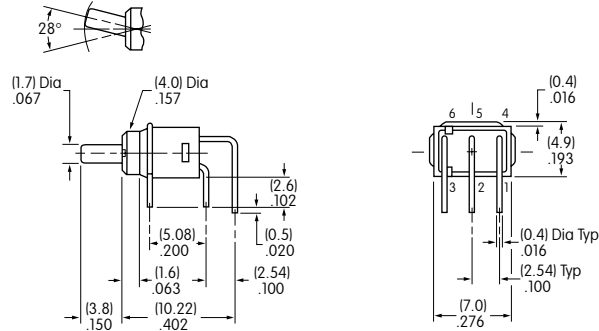

#### Vertical PC



G22AV

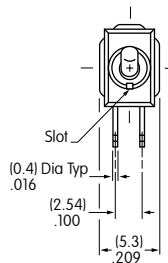

#### Single & Double Pole

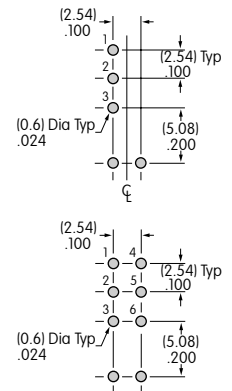
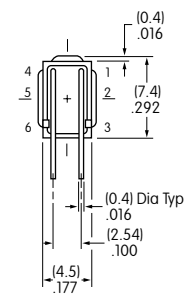
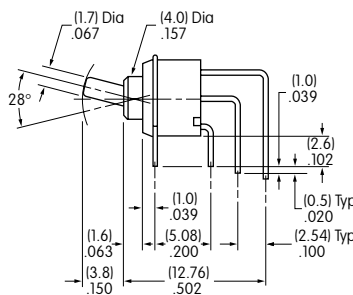

#### Straight PC with Rocker



G23KP-YA

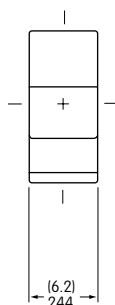

#### Single & Double Pole

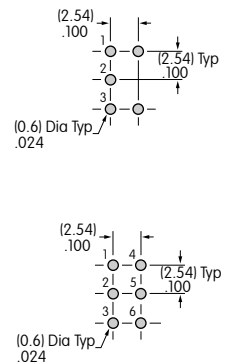
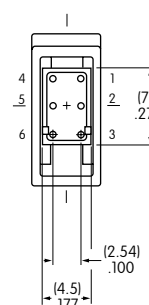
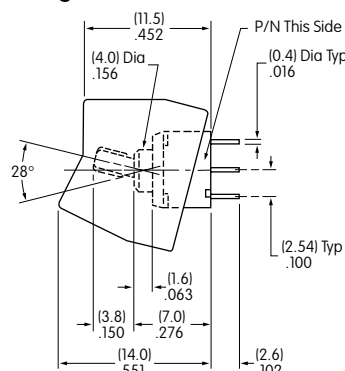

On single pole switches terminals 4 & 6 are support pins.